



HAPEVILLE TREE WIFI VOICE C6 196 LED

SKU# 1004213771

Safety Information

IMPORTANT SAFETY INSTRUCTIONS

When using electrical products, basic precautions should always be followed including the following:

a) **READ AND FOLLOW ALL SAFETY INSTRUCTIONS.**

b) This product is for indoor use only. The electrical rating 120V 60Hz 0.5A Max.

c) Do not use seasonal products outdoors unless marked suitable for indoor and outdoor use. When products are used in outdoor applications, connect the product to a Ground Fault Circuit Interrupting (GFCI) outlet. If one is not provided, contact a qualified electrician for proper installation.

d) This seasonal use product is not intended for permanent installation or use.

e) Do not mount or place near gas or electric heaters, fireplace, candles or other similar sources of heat.

f) Do not secure the wiring of the product with staples or nails, or place on sharp hooks or nails.

g) Do not let lamps rest on the supply cord or on any wire.

h) Unplug the product when leaving the house, when retiring for the night, or if left unattended.

i) This is an electric product – not a toy! To avoid risk of fire, burns personal injury and electric shock it should not be played with or placed where small children can reach it.

j) Do not use this product for other than its intended use.

k) Do not hang ornaments or other objects from cord, wire, or light string.

l) Do not close doors or windows on the product or extension cords as this may damage the wire insulation.



m) Do not cover the product with cloth, paper or any material not part of the product when in use.

n) Read and follow all instructions that are on the product or provided with the product.

o) **SAVE THESE INSTRUCTIONS.**

Pre-Assembly

Package Contents

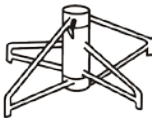
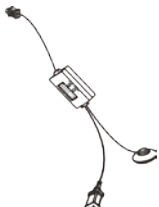
<p>A. Tree top Qty: 1</p> 	<p>B. Tree center Qty: 1</p> 	<p>C. Tree bottom Qty: 1</p> 
<p>D. Stand with an eye bolt Qty: 1</p> 	<p>E. Power cord Qty: 1</p> 	

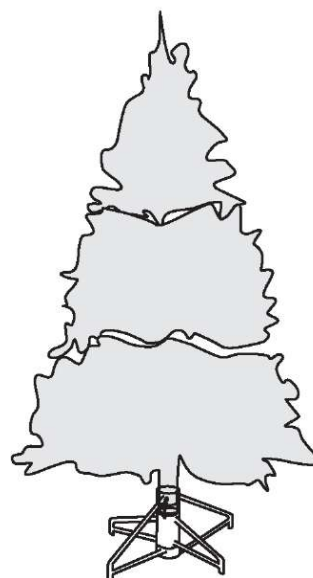

Assembly

Assembling the tree stand

Step 1. Choose a location near a wall outlet.

Step 2. Open the stand to a 90 degree angle until the hole lines up with the hole on the tube.

Step 3. Screw an eye bolt into the hole.

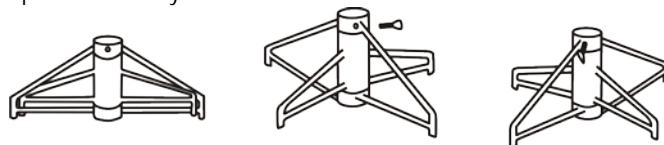

CAUTION! – ALWAYS UNPLUG YOUR TREE FROM ITS POWER SOURCE BEFORE ASSEMBLING OR DISASSEMBLING.

Assembling the tree

Please remove protective covers from the base of the pole for each tree section before assembling.

Step 1. Insert tree bottom (C) into the tree stand and tighten the screw. (See Fig. 1)

Step 2. Insert middle section (B) into the tree bottom (C). (See Fig. 2)

Step 3. Insert tree top (A) into the middle section (B). (See Fig. 3)

Step 4. Insert the provided power cord into the connector on the tree bottom (C) in right direction properly and tightly (always match the protuberance of the end connector of power cord to the concave of the connector found on the tree bottom (C) according to the magnified drawing on fig. 4.)

Step 5. Allow branches to fall into place or gently pull branches up and out. When adjusting branches be sure that all wires are free of branch hinges. (See Fig. 5)

Step 6. Shape the branches. Starting with tips closest to the pole, shape one tip to the right, one to the left and one at the center of the main stem. Repeat pattern for each branch. (See Fig. 6)

Step 7. Plug the power cord into a proper outlet. This tree comes with a control box and a foot pedal switch for easy illumination and changing functions. This tree is Color Changing, the 15 lighting options available are:

1. Steady On
2. Twinkle
3. Sparkle
4. Instead
5. Fade
6. Rolling

7. Waves
8. Fireworks
9. Rainbow
10. Color Band
11. Up and Down
12. Snow
13. Glow
14. Carnival
15. Alternate

These functions can be changed by using control box or foot pedal switch.

Please see **Instructions of control box** as below.

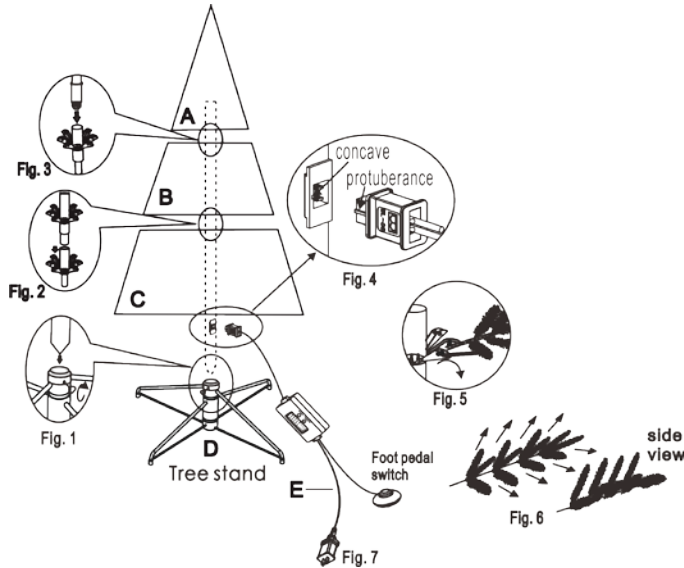

Operation

Turning on the tree

Step 1. Connect each tree section well and plug the well-connected power cord into a wall outlet.

Instruction of control box, wifi connection and Show Tree App

Function of the button on the control box

1. Press the Function/Reset button on control box:

Short press: switch 15 functions.

Long press at least for 5s: reset the Wi-Fi.

2. Press the Color/Timer button on control box:

Short press: switchover to 29 colors and theme.

Long press at least for 2s: set timer.

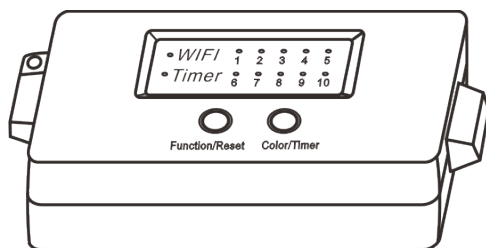

Description of the indicators on the control box

a. WiFi status indicator (Blue Led).

- Slow Flash (2 times every 3 seconds): Indicates that Wi-Fi is working in direct connection mode.
- Fast Flash (2 times every 1 second): Indicates that Wi-Fi is working in networking mode.



b. Function status indicator (White Leds).

The number corresponding to the LED is the serial number of the mode.



c. Timer status indicator (Green Led)

- When the green led is on, it indicates that the timer is on.
- When setting the timer, the corresponding number will flash three times to prompt the hours have been set.



Instruction of Wifi connection

There are two ways for Wifi connection:

1. Networking mode: Wifi signal indicator light stays on fast flash.
 2. Direct connection mode: Wifi signal indicator keeps flickering slowly.
- This two modes can be switchover by long pressing the "Function/Reset" button at least for 5s.

The wifi signal indicator on the control box flashes continuously for 3 minutes after the power is on.

You can connect wifi when wifi signal indicator is flashing.

Voice

If you need to use voice control, please ensure that:

- Show tree is connected to the network.
- Your Google assistant or Amazon alexa is connected to the network.

Voice control example for google:

- User: Ok, google, ask **Show-Home** (This is the brand name.)
- Google: You have voice converter and show tree and ultimate sting, which device do you want to control?
- User: **Show tree.** (This is the product name.)
- Google: Ok, voice converter is ready, which function do you want to try?
- User: **Red.** (Color name. Other colors and themes are shown as table 4-5-a)
- Google: Ok, the color has changed to red.
- User: **Steady.** (Mode name. Other modes are shown as table 4-5-b)
- Google: Ok, the mode has changed to steady.

(4-5-a)

COLOR NAME
Red
Green
Blue
White
Orange
Pink
Yellow
Gold
Cyan
Magenta
Purple
Christmas Day
Valentines' Day
Independence Day
Halloween
ST Patrick's Day
Thanksgiving
Multi-Color

(4-5-b)

MODE NAME
Turn on
Turn off
Steady
Sparkle
Twinkle
Fade
Waves
Rolling
Instead
Fireworks
Rainbow
Color Band
Up and down
Glow
Carnival
Alternate

How to control your Show Tree with APP

1. Download the "Holiday Showhome" App from App Store (IOS) or Google Play (Android).



2. Open the "Holiday Showhome" App and sign in.

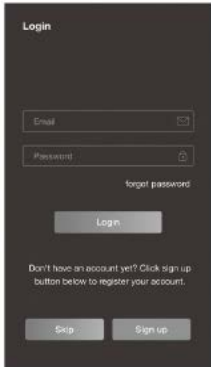

Notes: You can also click the skip button to skip the login screen and use the visitor mode, but you will not be able to use voice control at this time.

3. Click the Add Device button and select the Wi-Fi.



4. Click the Quickly add button after the scan is complete.



5. Return to the home interface and click on the device to enter the operation interface.



6. Now you have entered the operation interface of Show Tree.

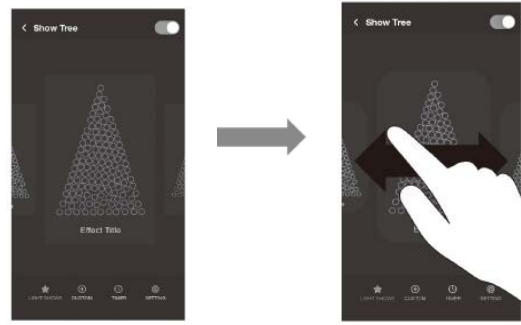

Browse effects by swiping left or right



Tap to select an effect

7. Edit Effects

- a. While playing an effect, press "ⓘ" to show current settings.
- b. Tap the color sample to change colors or "+" to create a custom color.

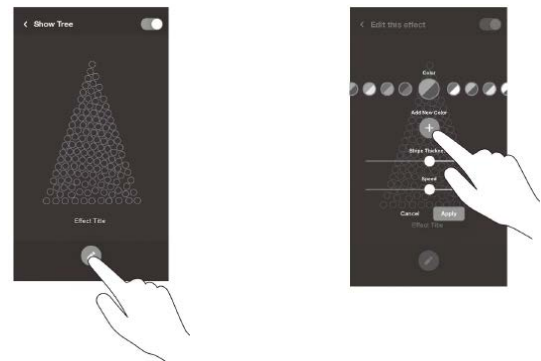

- c. Move sliders to increase/decrease speed and intensity of the effect.
- d. Tap "Apply" to store changes.

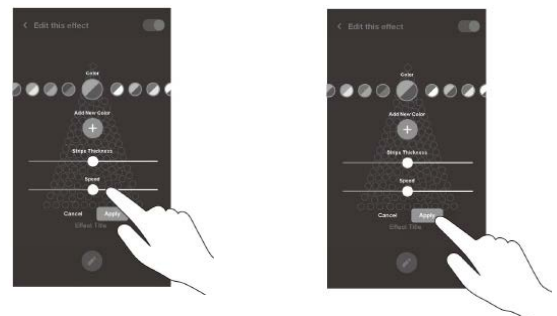

8. For more details, please scan the QR code below.



CAUTION: The product consists of non-replaceable LED lamps. To reduce the risk of fire or electric shock, do not attempt to replace lamps or modify string.

Care and Cleaning

- Step 1. Remove all ornaments and decorations.
- Step 2. Unplug the power cord from the wall outlet. And remove your power cord from tree bottom (C) and save them.
- Step 3. Gently lift the tree top straight up to remove from the center section and fold all branches towards the pole.
- Step 4. Repeat this step for the center and bottom tree sections.
- Step 5. Carefully place all tree sections into a shipping box and tape it shut.
- Step 6. Store your tree in a cool, dry place away from sunlight.

Troubleshooting

Problem	Solution
The tree does not light	Ensure that all tree sections are connected into each other well by pressing each section down and rotating. Make sure the power cord is well connected to the tree bottom (C) and that the tree is plugged into the wall outlet.
	If you are still experiencing problems with the tree please call 1-877-527-0313 for instructions.

FCC Caution.

This device complies with part 15 of the FCC Rules. Operation is subject to the following two conditions: (1) This device may not cause harmful interference, and (2) this device must accept any interference received, including interference that may cause undesired operation.

Any Changes or modifications not expressly approved by the party responsible for compliance could void the user's authority to operate the equipment.

Note: This equipment has been tested and found to comply with the limits for a Class B digital device, pursuant to part 15 of the FCC Rules. These limits are designed to provide reasonable protection against harmful interference in a residential installation. This equipment generates uses and can radiate radio frequency energy and, if not installed and used in accordance with the instructions, may cause harmful interference to radio communications. However, there is no guarantee that interference will not occur in a particular installation. If this equipment does cause harmful interference to radio or television reception, which can be determined by turning the equipment off and on, the user is encouraged to try to correct the interference by one or more of the following measures:

- Reorient or relocate the receiving antenna.
- Increase the separation between the equipment and receiver.
- Connect the equipment into an outlet on a circuit different from that to which the receiver is connected.
- Consult the dealer or an experienced radio/TV technician for help.

*RF warning for Mobile device:

This equipment complies with FCC radiation exposure limits set forth for an uncontrolled environment. This equipment should be installed and operated with minimum distance 20cm between the radiator & your body.

Importer: Home Depot
Address: 2455 PACES FERRY ROAD ATLANTA, GA 30339
Tel: 1-877-527-0313

Adapter Model No. XY24S-2401000L-UO